

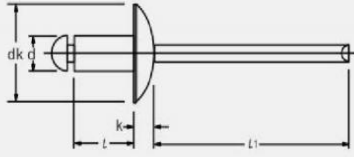

Pull-Through Blind Rivets (PT Rivets)

Manufacturer: RivetFast



Materials

Body

Stainless Steel

Body

Steel

d	$\frac{l}{+0.99}$	dk	Hole	Grip Range	K	Minimum Tensile Strength (N)	Minimum shear Strength (N)
3.0	2.1	4.9-5.5	3.1	1.2-1.5	0.75-1.0	800	700
3.0	2.4	4.9-5.5	3.1	1.5-2.0	0.75-1.0	800	700
3.0	2.8	4.9-5.5	3.1	2.0-2.5	0.75-1.0	800	700
3.0	3.3	4.9-5.5	3.1	2.5-3.0	0.75-1.0	800	700
3.0	3.8	4.9-5.5	3.1	3.0-3.5	0.75-1.0	800	700
3.0	4.3	4.9-5.5	3.1	3.5-4.0	0.75-1.0	800	700
3.0	4.8	4.9-5.5	3.1	4.0-4.5	0.75-1.0	800	700
3.0	5.3	4.9-5.5	3.1	4.5-5.0	0.75-1.0	800	700
3.0	5.8	4.9-5.5	3.1	5.0-5.5	0.75-1.0	800	700
3.0	6.3	4.9-5.5	3.1	5.5-6.0	0.75-1.0	800	700
3.2	2.1	4.9-5.5	3.3	1.2-1.5	0.75-1.0	800	700
3.2	2.4	4.9-5.5	3.3	1.5-2.0	0.75-1.0	800	700
3.2	2.8	4.9-5.5	3.3	2.0-2.5	0.75-1.0	800	700
3.2	3.3	4.9-5.5	3.3	2.5-3.0	0.75-1.0	800	700
3.2	3.8	4.9-5.5	3.3	3.0-3.5	0.75-1.0	800	700
3.2	4.3	4.9-5.5	3.3	3.5-4.0	0.75-1.0	800	700
3.2	4.8	4.9-5.5	3.3	4.0-4.5	0.75-1.0	800	700
3.2	5.3	4.9-5.5	3.3	4.5-5.0	0.75-1.0	800	700
3.2	5.8	4.9-5.5	3.3	5.0-5.5	0.75-1.0	800	700
3.2	6.3	4.9-5.5	3.3	5.5-6.0	0.75-1.0	800	700